

# Welcome to The RainForest

## upper level

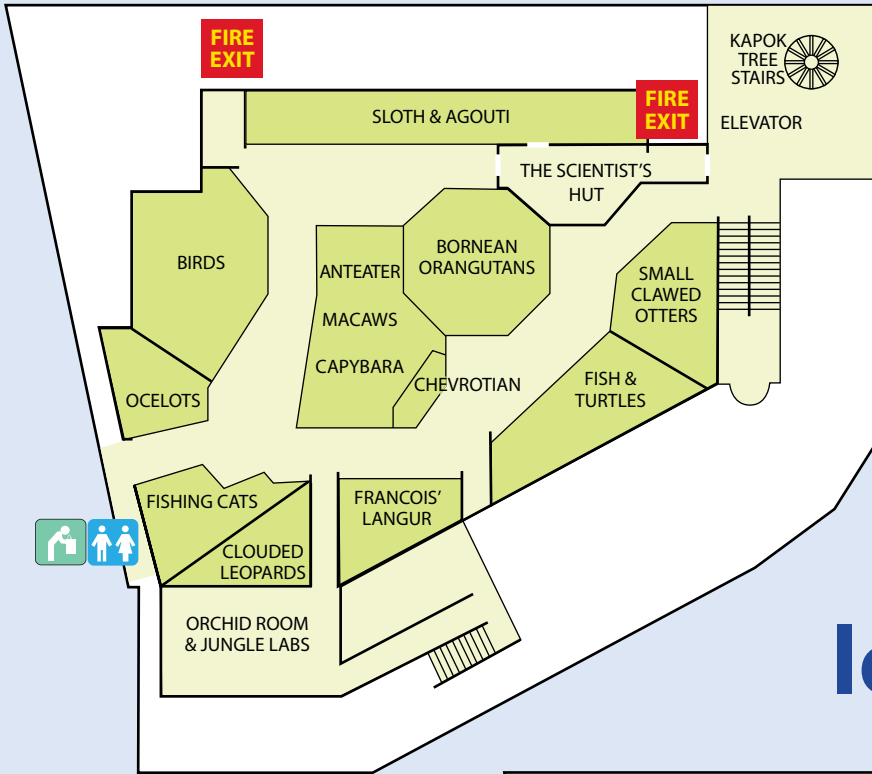

Your RainForest journey today will take you through the jungles of Asia, Africa and South America showcasing more than 6,000 plants and over 600 animals.

## lower level

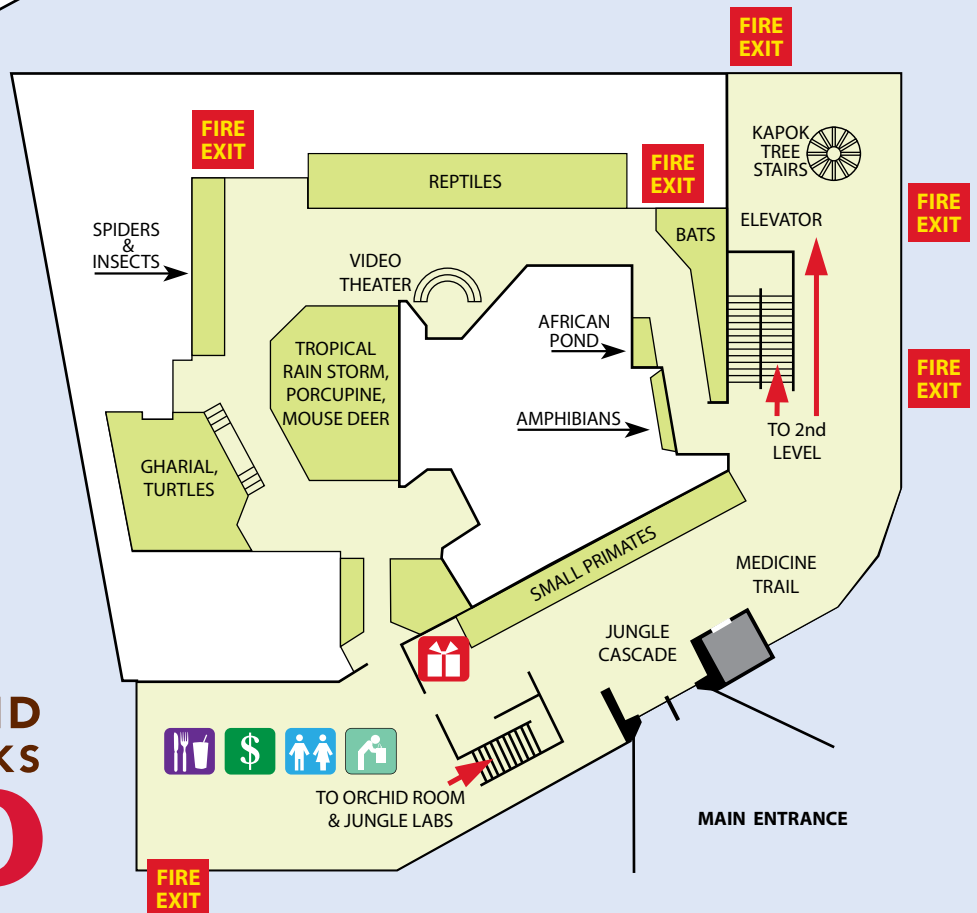

- PUBLIC ACCESS
- ANIMAL EXHIBITS
- AMAZON MARKETPLACE
- AMAZON CAFÉ
- WATER FOUNTAIN
- ATM
- RESTROOMS

Please take your map home or drop it in a recycle bin located at the Zoo Exit.





## The RainForest "Hot Spots"

**Bornean Orangutan Exhibit:** Located on the upper level, view a troop of Bornean orangutans demonstrate their arboreal nature by climbing 39 feet about visitors into The RainForest's geodesic dome.

**Tropical Rain Storm:** Sounds of thunder draw visitors to a large lower-level exhibit featuring Asian porcupines. Every 12 minutes, a tropical rainstorm occurs, complete with lightning, wind, thunder and rain

**Gharial Exhibit:** Next to the insects on The RainForest lower level, steps lead the visitor down to a split-level, eye-to-eye view of a unique crocodilian, the gharial - a unique species of crocodilian, characterized by its long, thin snout and the bulbous growth at the end of its snout.

## Daily RainForest Activities

(Memorial Day through Labor Day)

### Meet the Keeper

Monday	11 a.m.	Orangutans
Tuesday	2 p.m.	Otters
Wednesday	1 p.m.	Snake Feeding
Thursday	11 a.m.	Frogs
Saturday	4 p.m.	Gharial

A RainForest visit wouldn't be complete without a trip to

# Amazon Marketplace

Located on the lower-level, next to the Amazon Café, you'll find:

Plush animals

T-shirts

Mugs

Games & Toys

Much more!

# Special

Make any purchase at Amazon Marketplace or the main Gift Shop and receive a fun Cleveland Metroparks Zoo tote bag for only \$15 (a \$30 value).



proudly supports the summer season at Cleveland Metroparks Zoo.

Visit [clemet zoo.com](http://clemet zoo.com) or call (216) 661-6500 for all the latest Zoo news.